

# Wheatstone Manifolds

**Client:** FMC / Chevron

**Year:** 2012

**Location:** W Australia

## Description

Detail design of 8 diverless subsea manifolds ranging from 120-500 tonnes,

## Antares Scope

Detailed piping and structural analysis of dual and single header manifolds and PTS structures. Scope included:

Lift and transportation analysis

In-place analysis

FE analysis of joints and components

Mudmat design

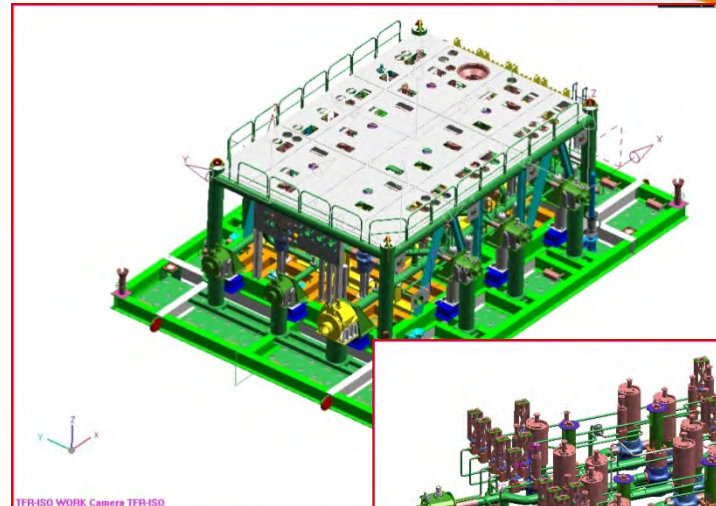

## Key features

- ✓ Diverless
- ✓ Horizontal connectors
- ✓ Unique foundations

## Project Profile

